

DO NOT SCALE
IF IN DOUBT ASK

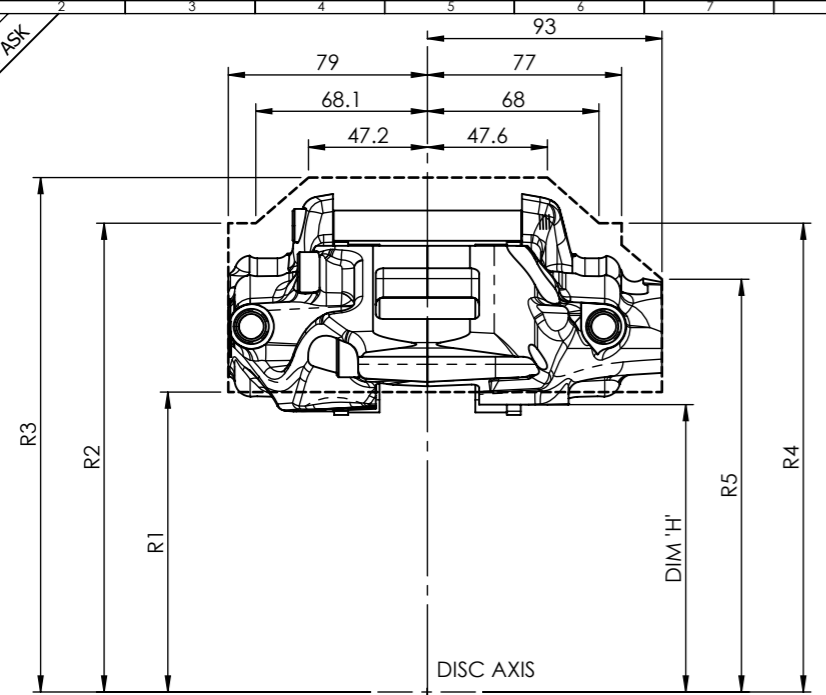

	R1	R2	R3	R4	R5	DIM 'H'
Ø390 DISC	136.5	199.5	216.3	199.5	181.3	131.5
Ø360 DISC	124	190	207.4	190	168.8	119
Ø355 DISC	119	186	204.1	186	163.8	114

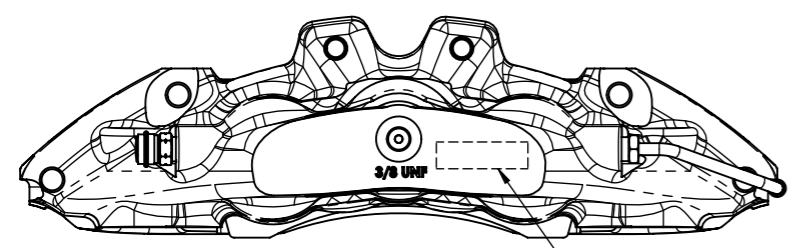

LASER ETCH ALCON PART NUMBER
M2M ISSUE LEVEL AND BATCH CODE
IN THIS AREA

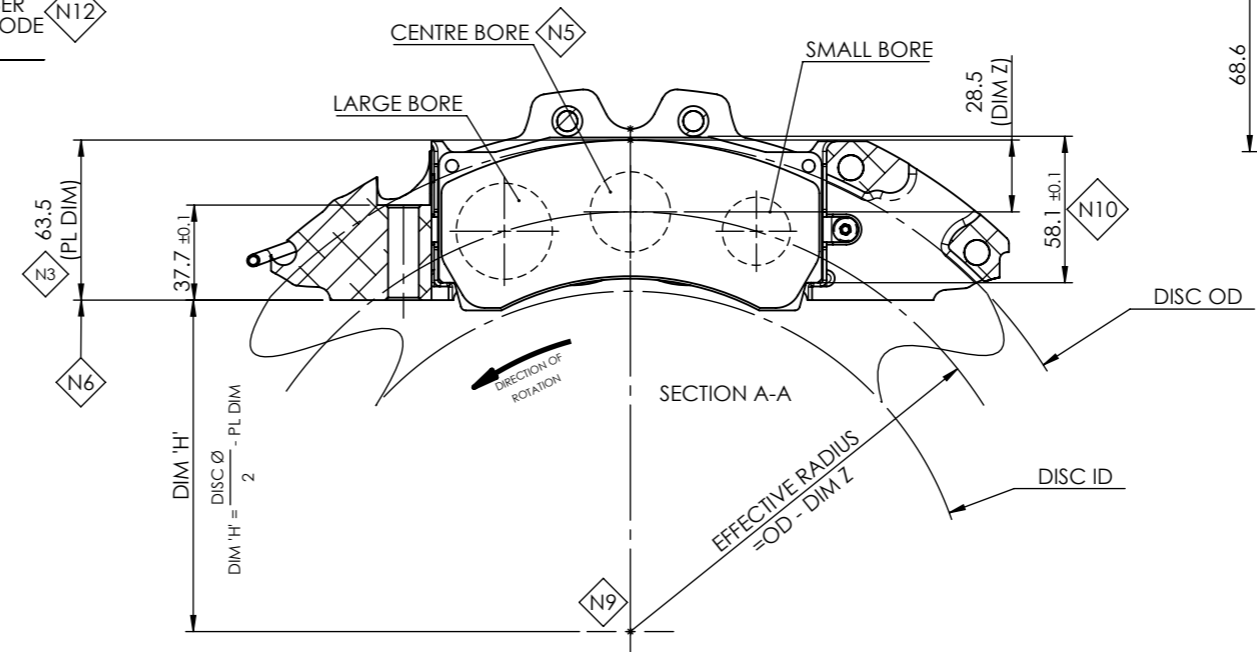
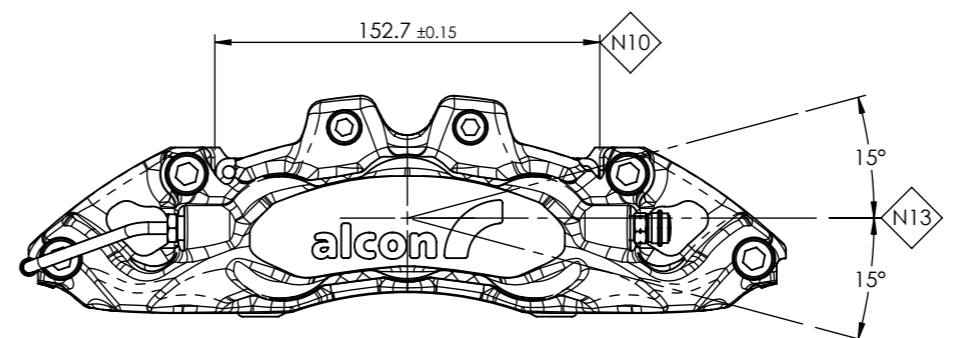
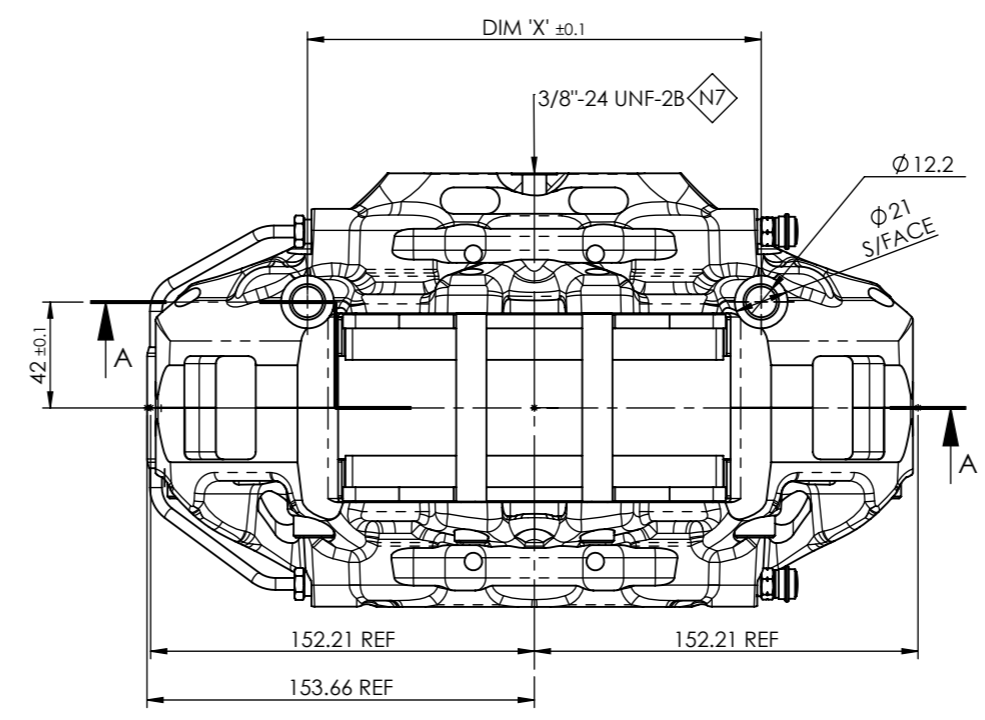
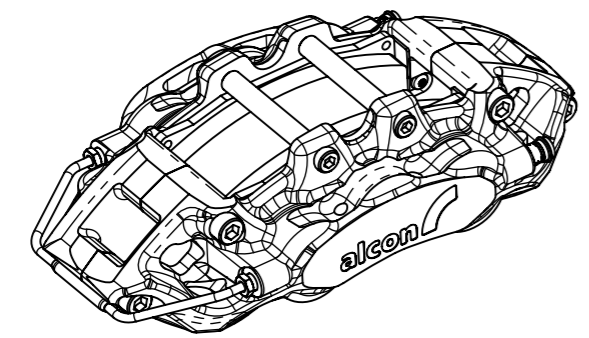

- NOTES:
- N1: LEFT HAND LEADING CALIPER AS DRAWN
RIGHT HAND LEADING CALIPER SYMMETRICALLY OPPOSITE
LEFT HAND TRAILING CALIPER EXTERNAL PIPE REVERSED
RIGHT HAND TRAILING CALIPER SYMMETRICALLY OPPOSITE
 - N2: BLEED SCREW: 3/8"-24 UNF, MAXIMUM TORQUE: 14Nm HOT
18Nm COLD
 - N3: INSTALL CALIPER WITH PAD LEVEL WITH O.D. OF DISC &
A MINIMUM CLEARANCE BETWEEN DISC & CALIPER OF 2.5mm
 - N4: ALL DIMENSIONS IN mm AND NOMINAL UNLESS OTHERWISE STATED
 - N5: TOTAL CALIPER PISTON AREA: SEE TABLE
 - N6: CALIPER MOUNTING FACE
 - N7: FLUID INLET
 - N8: CALIPERS SUPPLIED LESS PADS
 - N9: DISC AXIS
 - N10: DIMENSIONS FOR PAD FITMENT
 - N11: ASSEMBLY WEIGHT (LESS PADS): 3.18Kg (EST)
 - N12: LASER MARKING INSTRUCTIONS
 - N13: RECOMMENDED INSTALLATION ANGLE +/-15° FROM VERTICAL

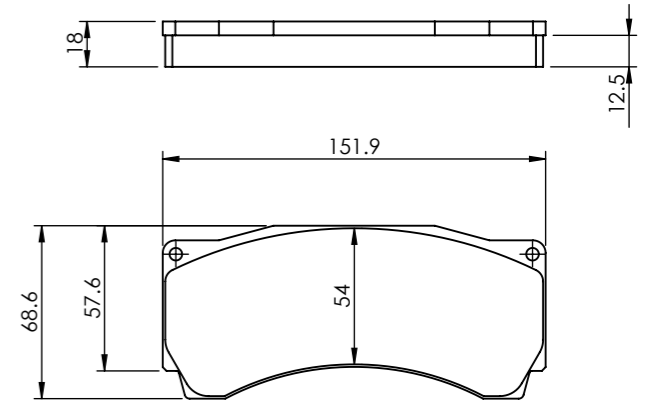

▣ N8 PAD SHAPE - RC4489
PAD THICKNESS - 18
PAD MATERIAL THICKNESS - 12.5
FRICTION MATERIAL AREA - 80cm²
VOLUME PER CALIPER - 200cm³

CAR8959Y24SSRL / RT	RIGHT	LEADING TRAILING	36	Ø27.0	Ø31.8	Ø38.1	180	50.13cm²	
CAR8959Y24SSLL / LT	LEFT	TRAILING LEADING							
Alcon Part No.	Hand	Orientation	Disc Thickness	Small Bore	Centre Bore	Large Bore	Hole centres DIM 'X'	Piston Area	Remarks

A	FIRST ISSUE	CJG 08.02.16	GW 08.02.16	SH 08.02.16	
Issue	Change	LOC	DRN BY / Date	CHK BY / DATE	APP BY / Date
DRAWN IN SOLIDWORKS	SCALE 1:3	DESIGNED BY C GOODYEAR	ALCON COMPONENTS LIMITED APOLLO TAMWORTH STAFFORDSHIRE B79 7TN TEL: +44(0)1827 723700		
WEIGHT 3410.86 grams	MATERIAL	DATE 08.02.16	alicon engineering your advantage		
REMOVE ALL SHARP EDGES, BURRS AND SWarf	FINISH	DATE 08.02.16	NOTE: THIS DRAWING AND INFORMATION THERE UPON IS THE PROPERTY OF ALCON COMPONENTS LTD. IT IS LENT ON THE CONDITION THAT IT IN WHOLE OR IN PART, SHALL NOT BE REPRODUCED, COPIED, LENT OR DISCLOSED TO ANY PERSON WITHOUT WRITTEN CONSENT OF ALCON AND SHALL BE RETURNED TO ALCON COMPONENTS LTD.		
ALL DIMENSIONS ARE BEFORE TREATMENT UNLESS STATED	HEAT TREATMENT	DATE 08.02.16	PART NAME (Max. 80 chars):		
TOLERANCES UNLESS STATED ±0.2 ANGLES 80°/9°	SURFACE TREATMENT	DATE 08.02.16	PART NUMBER: CAR89181		
			REV. NO.	REV. DATE	REV. BY
			A		1 of 1
					A3